

Cabinet Model Turner

Supplemental Maintenance Manual

The automatic turner in GQF cabinet model incubators is strong, reliable, and built for years of service. The sheet is supplied for your convenience should replacement of turner components be necessary.

- UNPLUG INCUBATOR BEFORE SERVICING -

Drive Motor Maintenance

Item No. 3022

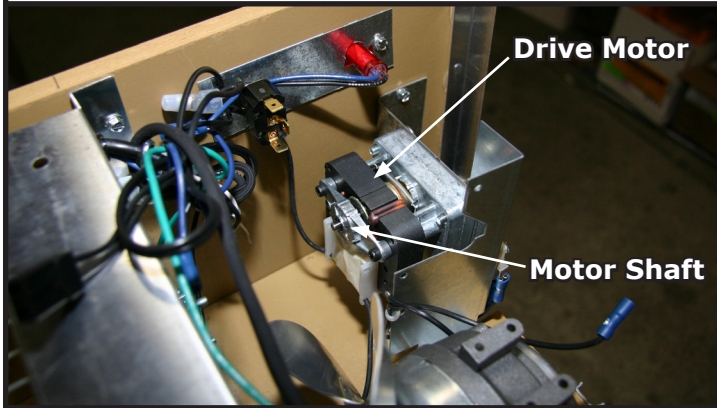

NOTE: some components have been removed in the above image
The turner DRIVE MOTOR can sometimes seize preventing the turning trays from moving manually or automatically. This can be caused by corrosion, accumulated dust, or if the spring located around the motor shaft becomes misaligned.

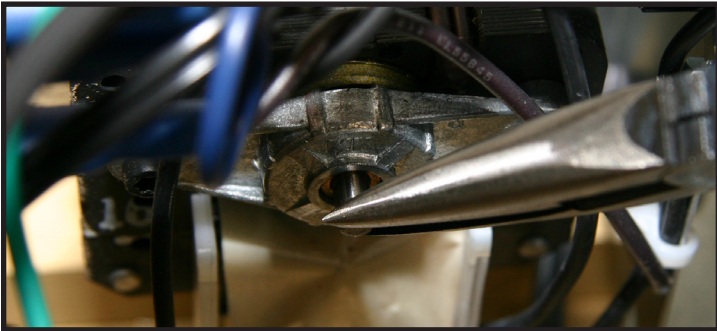

The motor can be freed by pulling the motor shaft forward with pliers or by hand and rotating it. This should cause the shaft to loosen or the spring to realign itself. If this does not correct the problem the DRIVE MOTOR may need to be replaced.

Roller Switch Adjustment

Item No. 3024

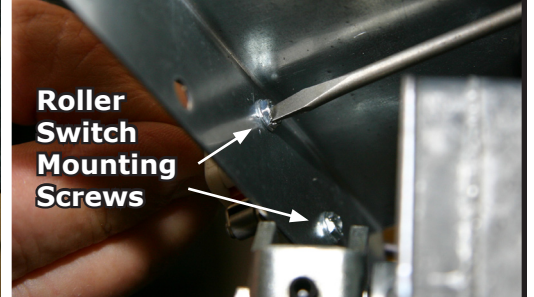
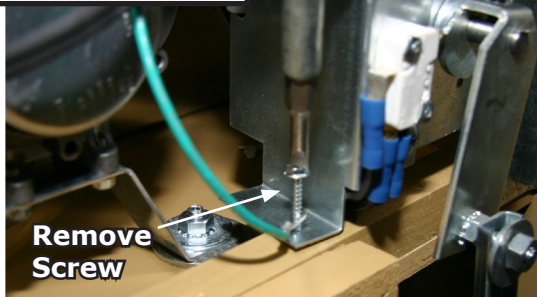
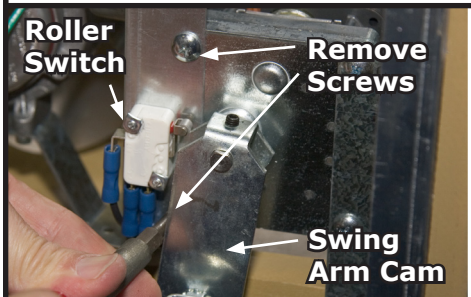

If the ROLLER SWITCH becomes misaligned, the turner can operate constantly when set on automatic. If this occurs the ROLLER SWITCH needs to be moved closer to the SWING ARM CAM. Remove the 3 screws indicated above. This will allow the mounting bracket to be moved and grant access to the ROLLER SWITCH mounting screws. Loosen the mounting screws and move the switch closer to the swing arm cam. Tighten the mounting screws to lock the switch in the new position. Reinstall the mounting bracket using the 3 screws previously removed.

Timer Motor Replacement

Item No. 3023

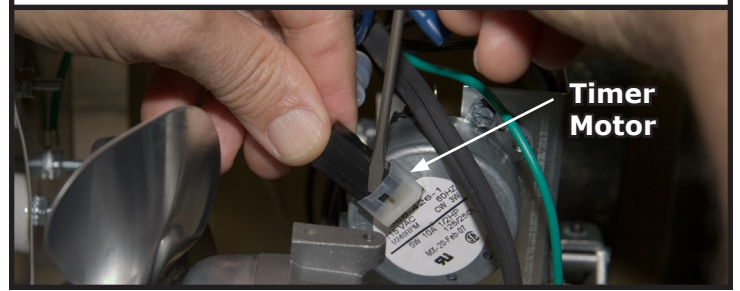

If the TIMER MOTOR fails, the turner will usually turn manually, but not when set to automatic. To replace the motor, disconnect the black connector on the front of the motor as shown above.

A small Flat Blade screw driver may be used to release the connectors.

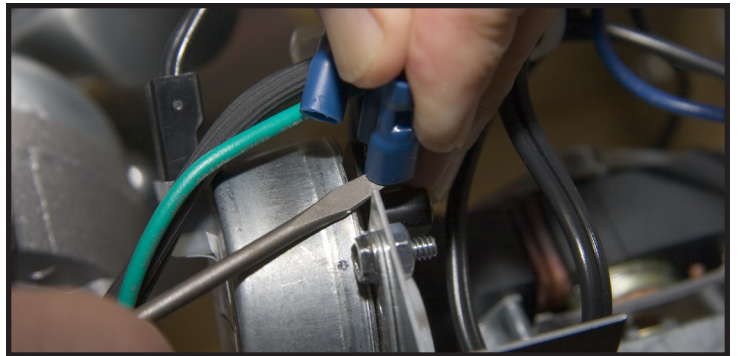

Remove the connectors from the rear of the TIMER MOTOR.

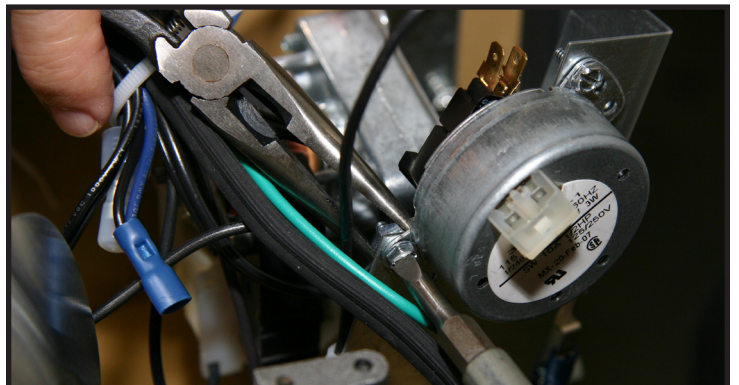

Remove the 2 nuts and 2 machine screws holding the TIMER MOTOR in place. Carefully remove from incubator. Install replacement in reverse order.

G.Q.F. MANUFACTURING COMPANY

WWW.GQFMFG.COM - 912-236-0651